

PRODUCT INFORMATION

Bathrooms Leila Roberts

FIRED EARTH

Atlantic Washstand – Glass Legs



Product Code

ATLWASG

Features and Benefits

- Elegant Art Deco styling.
- High quality brass work and electroplating.
- Glass legs provide a luxurious alternative to the classic metal-legged stand.
- Available in choice of Chrome, Polished Nickel or Antique Gold finishes.
- 2 towel bars.
- Assembled in the UK.
- Every piece rigorously inspected at every stage of the manufacturing process.

FAQ's

- (Q) Is it simple to install?
(A) Yes but we always suggest that a professional installer is used.
- (Q) Is it supplied with any fixings?
(A) Yes, the washstand comes with fixings. Details of the fixings are detailed below.
- (Q) What is the specification of the glass used?
(A) Duran Rod manufactured from Borosilicate 3.3 glass, 30mm diameter not toughened.
- (Q) How do I clean and maintain the product?
(A) Refer to maintenance section.

Product Information

Analysis code 1: PBAT

Available from: August 2014

Ordering process: Available to special order. Check PU for current lead times.

The up to date version (controlled document) is on the Fired Earth intranet. Always check any printed version before use.

Product Manual: Atlantic Washstand – Glass Legs

PRODUCT INFORMATION

Bathrooms Leila Roberts

FIRED EARTH

Atlantic Washstand – Glass Legs

Dimensional Drawing

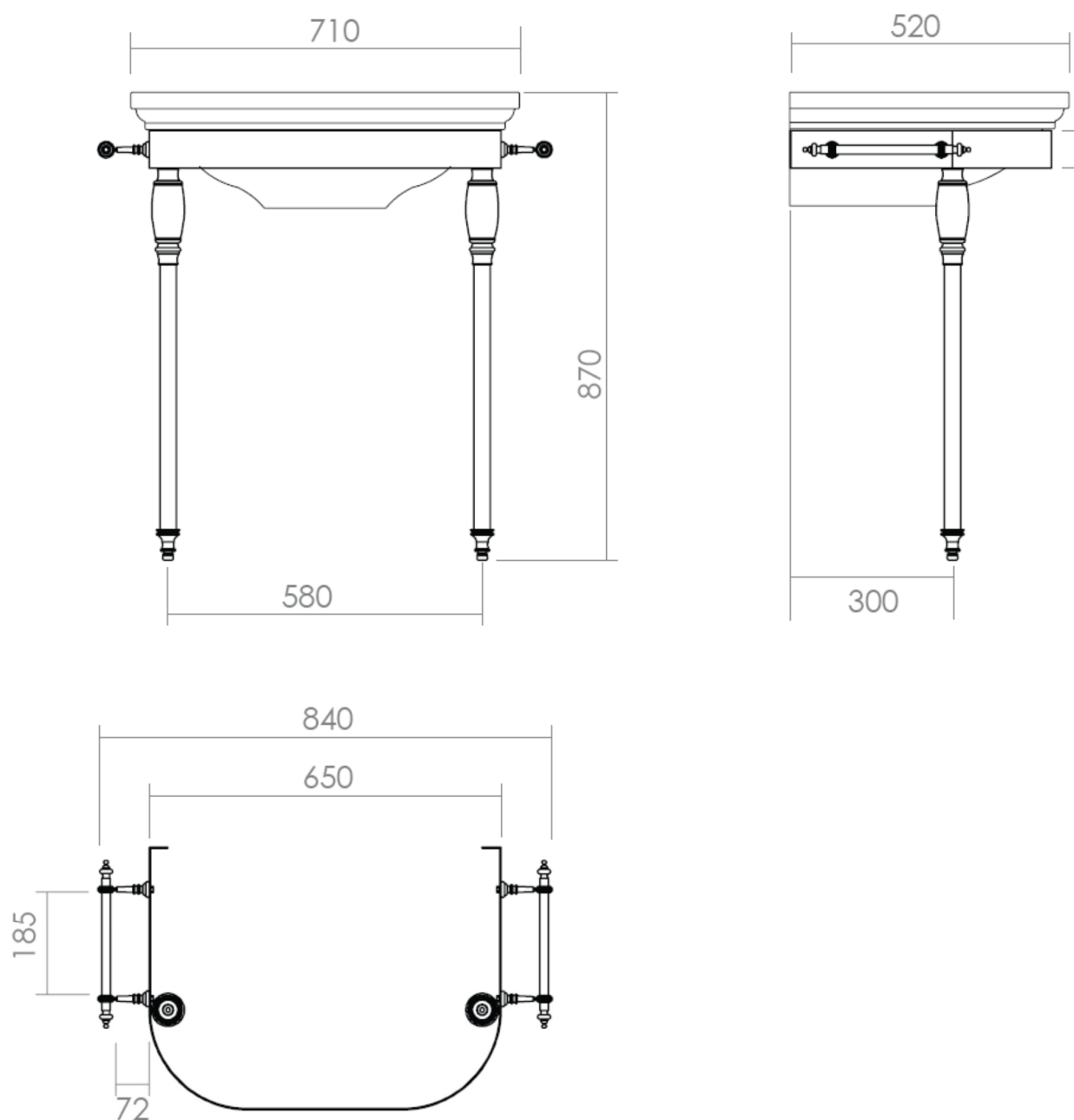

The up to date version (controlled document) is on the Fired Earth intranet. Always check any printed version before use.

PRODUCT INFORMATION

Bathrooms Leila Roberts

FIRED EARTH

Atlantic Washstand – Glass Legs

Pack Contents

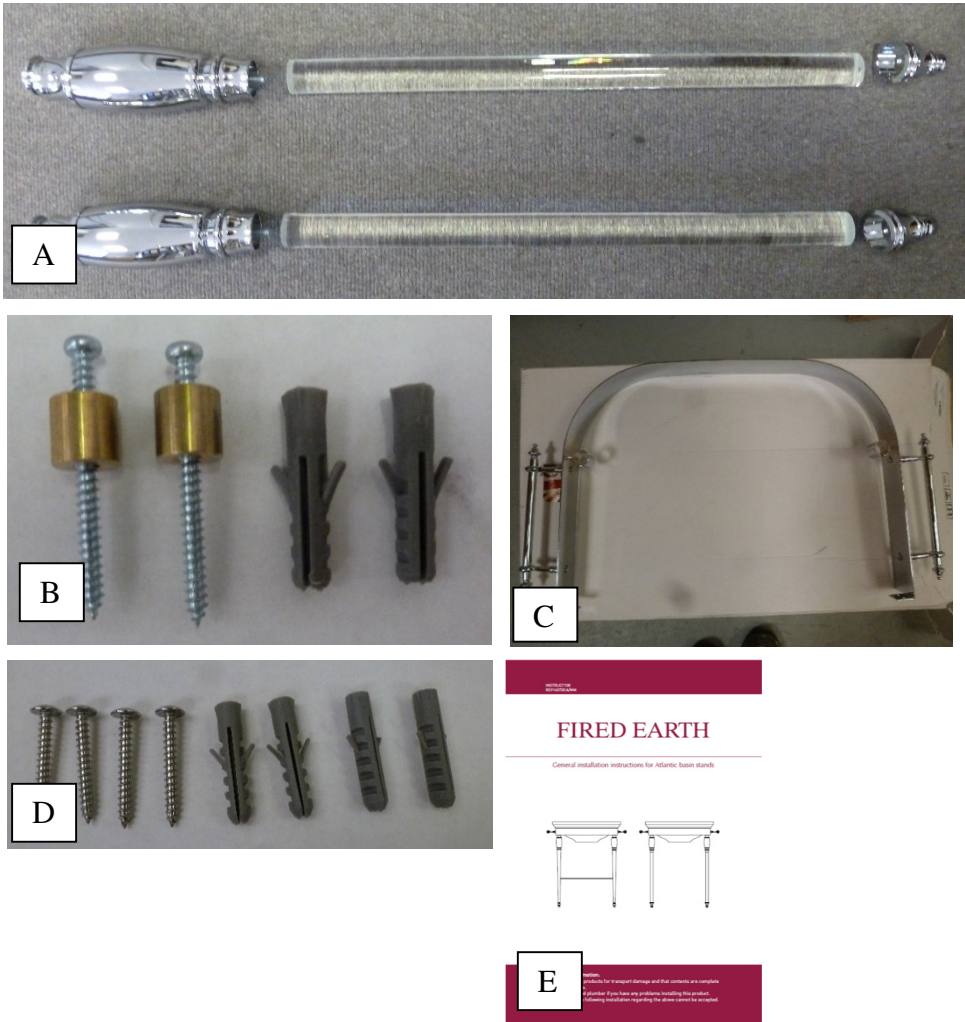

Item	Description	Qty
A	Glass Leg Kit	2
B	Glass Leg Kit Fixings	1
C	Top Frame	1
D	Top Frame Fixings - Screws (x4) Wall Plugs (x4)	1
E	Installation Instruction	1

The up to date version (controlled document) is on the Fired Earth intranet. Always check any printed version before use.

PRODUCT INFORMATION

Bathrooms Leila Roberts

FIRED EARTH

Atlantic Washstand – Glass Legs

Maintenance/Care Instructions

SEE INSTALLATION INSTRUCTIONS

Atlantic Washstand – Glass Legs

Assembly and Installation Instructions

CAUTION!



**GLASS LEGS ARE VERY FRAGILE!
IF THE ANCHOR BOLTS ARE NOT
FITTED - THE LEG CAN BRAKE
RESULTING IN ANY WARRANTY
OR GUARANTEE BEING VOID.**

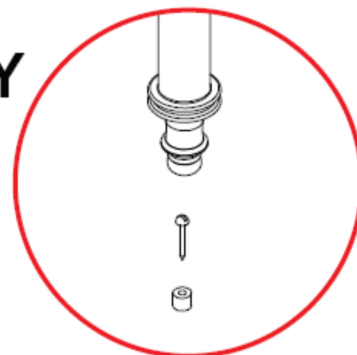

EXTREMELY FRAGILE CONTENTS



Small components included in polystyrene blocks.
PLEASE LOCATE BEFORE DISPOSING OF PACKAGING

Petits composants moulés dans un bloc de
polystyrène. Conservez l'emballage pour vérifier que
vous disposez de tous les composants.

Atlantic Washstand – Glass Legs

INSTRUCT108
REV140730 A/MM

FIRED EARTH

General installation instructions for Atlantic basin stands

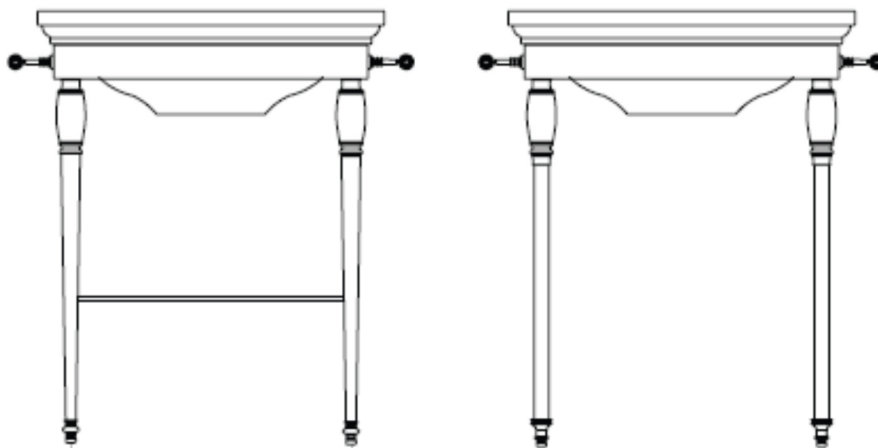

Important Information:

Please check the products for transport damage and that contents are complete before installation.

Consult a qualified plumber if you have any problems installing this product.

Complaints made following installation regarding the above cannot be accepted.

Atlantic Washstand – Glass Legs

Thank you for purchasing this product. These instructions relate to the following products.



Atlantic glass leg basin stand



Atlantic chrome leg basin stand



Before you start:

Check you have the necessary tools for the installation. It is advisable to prepare a clear area to assemble the products. Lay a soft blanket or sheet to protect the metal finish from scratches.

Tools Required



Hand Held Drill



Safety Goggles



Spirit Level



Tape Measure



Pencil

Assembly Instructions

Ref	Part	Qty
a	Leg assembly	x2
b	Floor screw & stud set	x2
c	Glass shelf *	x1
d	Shelf stud *	x2
e	Towel rail	x2
f	Leg securing nut	x2
g	Wall screws	x4

*Not compatible with glass leg stand

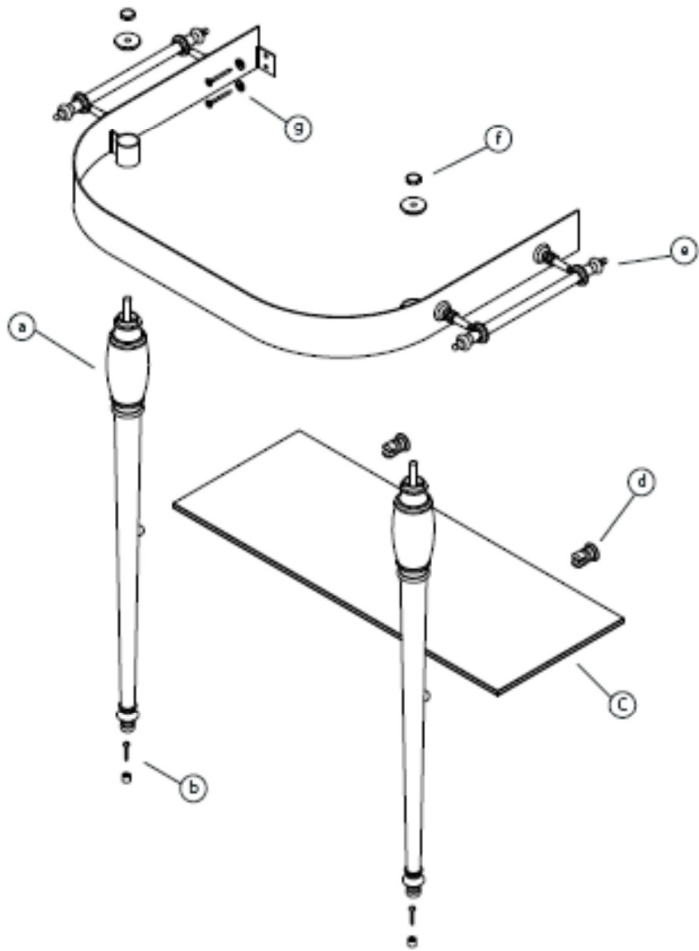

Atlantic Washstand – Glass Legs

1: Offer up one of the assembled legs to the locating ring on the inside of the trim section. Tighten down the leg securing nut onto the top of the ring, securely tighten the leg with the shelf stud (not applicable to glass leg stand) facing the wall. Repeat this process with the second leg.

2: Position the assembled stand in the required position against the wall to which it is to be attached.

3: Ensure that the legs are standing fully upright and perpendicular to the floor. Also ensure that the sides of the trim are sitting square and true to the wall.

4: Mark the wall where the screw holes will need to be drilled. Mark the floor around the foot of the unit.

5: Measure the distance marked 'Z' on the diagram and add 4mm to determine the correct height for the shelf studs to be affixed to the wall. The spacing of the studs should be the width of the shelf minus 140mm. It is suggested that each stud should be inset from the edge of the glass by 70mm. Mark the wall according to this guideline.

CAUTION: Before carrying out the following steps ensure there is no hidden pipework or cables in the area that you intend to drill.



Always ensure that you take the necessary safety precautions.

NOTE: It may be wise at this stage to double check that the holes and markings for fixing are correct. Ensure that the stand will stand square and true to the wall and floor.

6: Remove the stand from the wall and drill appropriate sized holes for the insertion of screw plugs. Insert plugs into wall.

7: If necessary drill pilot holes into the floor where the location of the floor pegs will be.

8: Position the floor pegs carefully and screw them into position.



CAUTION: Affixing the floor pegs is a critical measure in ensuring the safe and proper installation of this product. This is a health and safety measure and must be carried out in order to maintain the structural integrity of the stand.

9: Locate the stand onto the floor pegs and align the holes in the side trim with the plugs in the wall. Using the screws and washers fix the stand into position.

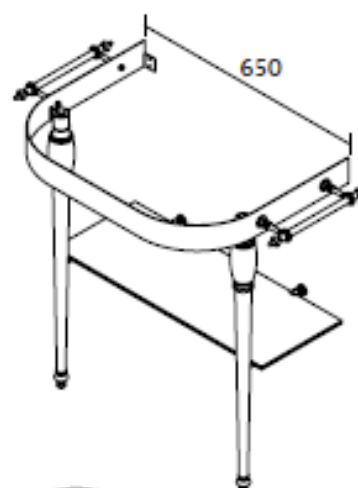
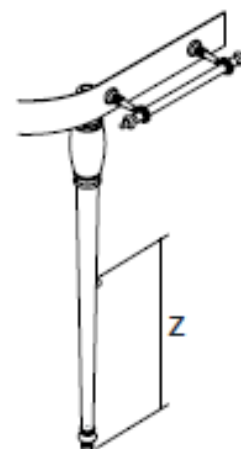

Atlantic Washstand – Glass Legs**Assembly Instructions**

10: Carefully lower the Atlantic basin into position on the basin stand - taking care not to scratch the front of the basin on the metal trim. You should now follow the instructions provided within your Atlantic basin in order to affix it to the wall.

11: Once you are happy with the installation of the basin and the stand, proceed to seal the rear of the basin with the wall using a thin bead of silicon sealant. You are now ready to complete the necessary plumbing in of taps and waste fittings.

Care & Maintenance

You have just acquired a high quality and expensive piece of furniture and are about to put it in the most hostile environment in the house! We have been producing these fine products for many years and our experience is that they will give years of pleasurable service if a few simple measures are taken to look after them.

Ceramic

The glazed finish of your sanitary ware should be cleaned after use by applying a little cream type cleaner. Apply using a sponge or damp cloth and rinse thoroughly with clean water. Cleaners containing abrasive materials should be avoided.

Metal

Parts with Chrome/Gold finish should be cleaned with a damp soft cloth only. The use of detergents and abraasive cleaning agents should be avoided as these will cause damage to the finish of the metal.

PRODUCT INFORMATION

Bathrooms Leila Roberts

FIRED EARTH

Atlantic Washstand – Glass Legs

Warehouse Description

Packaging

Net Weight: 11.78Kg

Gross Weight: 12.78Kg

No. of boxes per product code: 1

Dimensions of outers: 380x990x645mm

How many inners per outer: 2

Dimensions of inner: N/a

Agreed packaging standard: 5mm Double corrugated cardboard, brown with Fired Earth printing

Label specification:



Fired Earth Code: ATLWASG

The up to date version (controlled document) is on the Fired Earth intranet. Always check any printed version before use.

Product Manual: Atlantic Washstand – Glass Legs